

Threshold plates

Performance without restriction

Our range of aluminium and stainless steel threshold plates provide a **stylish connection between** two rooms or spaces, covering the gap between different floor types and thicknesses. The range can be supplied with or without pre-drilled holes, providing the option for a more practical, screwed installation or a more aesthetic, screw-free installation with adhesive.

Threshold plates provide an optimal sealing surface for our drop seals to seal against. The majority of the range is low-profile, designed with a focus on minimising impact on movement through a building. Our range also consists of certified **barrier-free solutions** to cater to recent construction trends and the rapidly growing sector of barrier-free living.



Threshold plates



COMFORT-PLAN®

THERMALLY SEPARATED THRESHOLD SET

GUARANTEED BARRIER-FREE PLANNING

- / Architects and designers can guarantee barrier-free construction to the latest DIN standards

ACCESSIBILITY FOR ALL

- / Rollability tests prove the set's accessibility – ideal for wheelchair users, prams and rollators

BUILT-IN WEATHERPROOFING

- / The Comfort-Plan® set is supplied with the Rainstop® dropseal to satisfy weatherproofing requirements

TWO STANDARD SIZES AVAILABLE

- / A ready-made 78 & 88 mm solution is available for both commercial and private timber entrance doors.

THERMAL SEPARATION

- / Comfort-Plan® is thermally-efficient, featuring a central thermal break

Comfort-Plan®

- / weatherproof, barrier-free threshold solution
- / barrier-free compliant
[DIN 18040-1 & DIN 18040-2]
- / resistance to driving rain [EN 12208]
- / provides thermal break

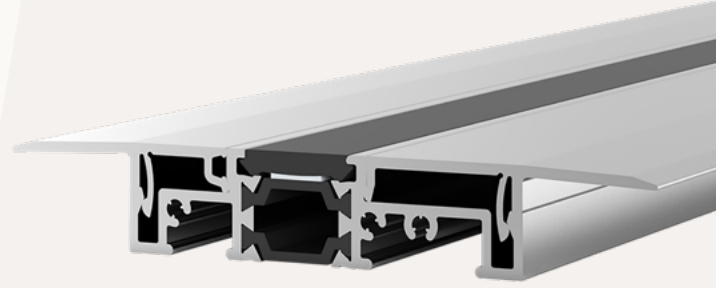

TECHNICAL DATA

Application	door threshold
Standard lengths	1300, 1450, 1600, 1750mm

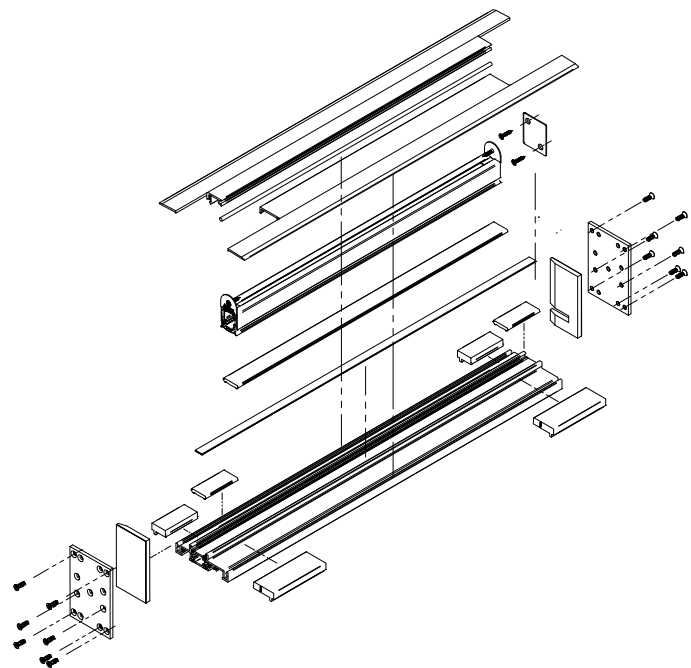
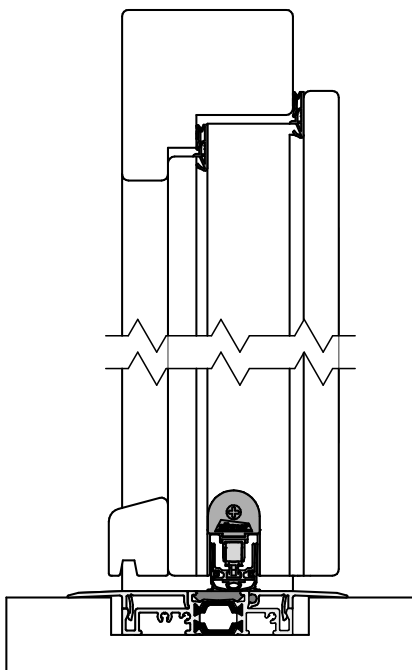

ART.NO.

Comfort-Plan® 78	3-278
Comfort-Plan® 88	3-288

Thresholds

- / recommended for optimal acoustic performance
- / range of options for use with both carpets and tiled floors
- / low profile, suitable for disabled access
- / stainless steel (Niro) or aluminium (Alu) profiles supplied with protective film

TECHNICAL DATA	Niro	Alu
Application	at the threshold of doorsets	
Material	stainless steel	aluminium
Fixing	bonded with adhesive or fixed with screws (not supplied)	

ART.NO.	Niro 164	Niro 365	Niro 288	Niro 513
	3-107	3-135	3-103	3-150
	Alu 090	Alu 253	Alu 088	Alu 277
	3-111	3-114	3-117	3-104
	Alu 308	Alu 278	Alu 217	Alu 496
	3-120	3-108	3-100	3-152

DIMENSIONS

Niro 164

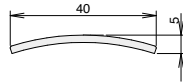

Niro 365

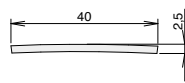

Niro 288

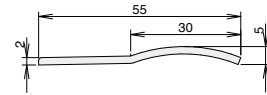

Niro 513

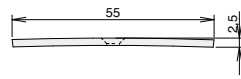

Alu 090

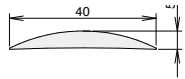

Alu 253

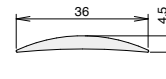

Alu 088

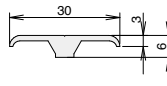

Alu 277

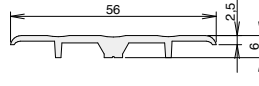

Alu 308

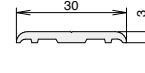

Alu 278

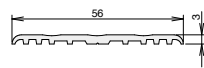

Alu 217

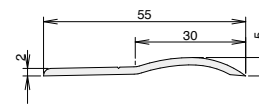

Alu 496

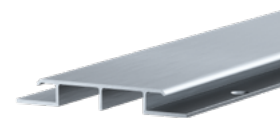
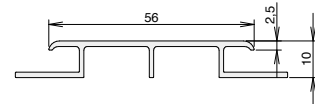



AT 07506

/ saddle threshold with low profile

TECHNICAL DATA

Application	at the threshold of hinged single and double action doors
Material	aluminum, anodized

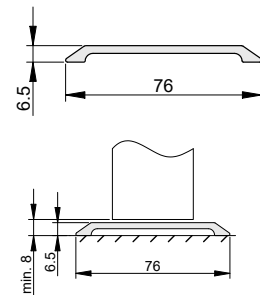

DIMENSIONS

Width x height	76 x 6.5 mm
Bottom gap size	≥8 mm
Standard lengths	1.000, 2.250, 2.500, 3.000 mm
Max. lengths	3.000 mm
Can be shortened by	any lengths

FIXING

Fixing	screw fixed to the floor with screws and anchors
--------	--

PERFORMANCE & CERTIFICATES

UL	UL 10C (R38166)
----	-----------------

COLORS

ART.NO.

Silver anodized	P160197
-----------------	---------



AT 10006

/ saddle threshold with low profile

TECHNICAL DATA

Application	at the threshold of hinged single and double action doors
Material	aluminum, anodized

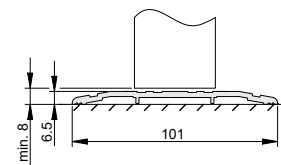
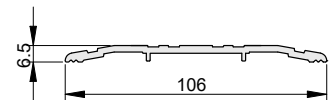

DIMENSIONS

Width x height	106 x 6.5 mm
Bottom gap size	≥8 mm
Standard lengths	1.000, 2.250, 2.500, 3.000 mm
Max. lengths	3.000 mm
Can be shortened by	any lengths

FIXING

Fixing	screw fixed to the floor with screws and anchors
--------	--

PERFORMANCE & CERTIFICATES

UL	UL 10C (R38166)
----	-----------------

COLORS

ART.NO.

Silver anodized	P160198
-----------------	---------



AT 12706

/ saddle threshold with low profile

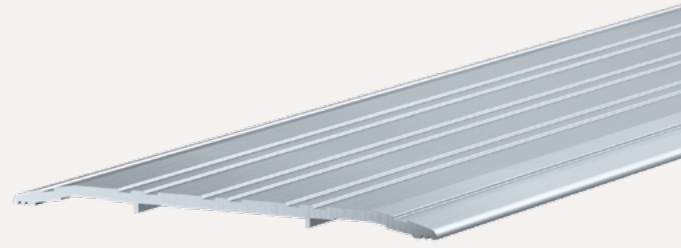

TECHNICAL DATA

Application	at the threshold of hinged single- and double action doors
Material	aluminum, anodized

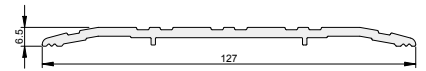

DIMENSIONS

Width x height	127 x 6.5 mm
Bottom gap size	≥8 mm
Standard lengths	1.000, 1.250, 2.250, 2.500, 3.000 mm
Max. lengths	3.000 mm
Can be shortened by	any lengths

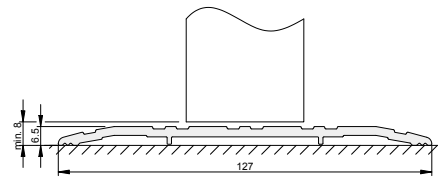

FIXING

Fixing	screw fixed to the floor with screws and dowels
--------	---

PERFORMANCE & CERTIFICATES

UL	UL 10C (R38166)
----	-----------------

COLORS

Silver anodized	ART.NO. P160084
-----------------	-----------------



AT 15006

/ saddle threshold with low profile

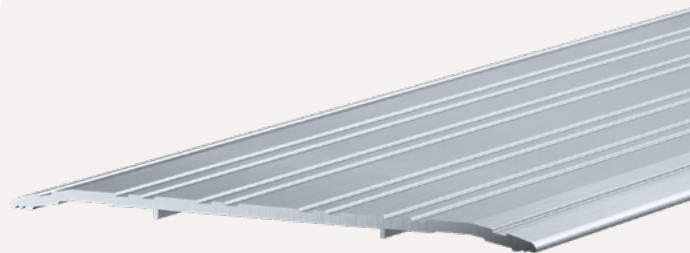

TECHNICAL DATA

Application	at the threshold of hinged single action doors
Material	aluminum, anodized

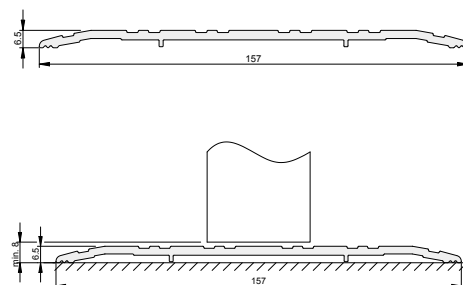

DIMENSIONS

Width x height	157 x 6.5 mm
Bottom gap size	≥ 8 mm
Standard lengths	1.000, 1.250, 2.250, 2.500, 3.000 mm
Max. lengths	3.000 mm
Can be shortened by	any lengths

FIXING

Fixing	screw fixed to the floor with screws and dowels
--------	---

PERFORMANCE & CERTIFICATES

UL	UL 10C (R38166)
----	-----------------

COLORS

Silver anodized	ART.NO. P160092
-----------------	-----------------

6 Threshold plates
6.2 stainless steel & aluminium plates

athmer.com



AT 12713

/ saddle threshold with high profile



TECHNICAL DATA

Application	at the threshold of hinged single- and double action doors
Material	aluminum, anodized



DIMENSIONS

Width x height	127 x 13 mm
Bottom gap size	≥15 mm
Standard lengths	1.000, 1.250, 2.250, 2.500, 3.000 mm
Max. lengths	3.000 mm
Can be shortened by	any lengths

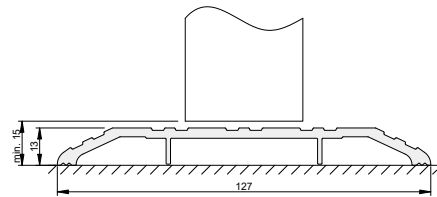

FIXING

Fixing	screw fixed to the floor with screws and dowels
--------	---

PERFORMANCE & CERTIFICATES

UL	UL 10C (R38166)
----	-----------------

COLORS

Silver anodized	ART.NO. P160086
-----------------	-----------------



AT 15213

/ paddle threshold with low profile

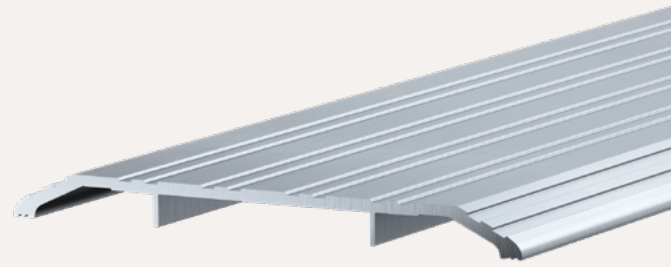

TECHNICAL DATA

Application	at the threshold of hinged single action doors
Material	aluminum, anodized

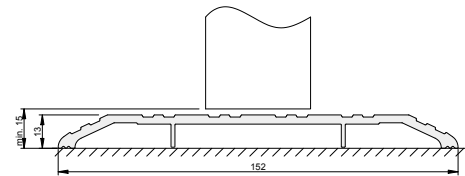

DIMENSIONS

Width x height	152 x 13 mm
Bottom gap size	≥15 mm
Standard lengths	1.000, 1.250, 2.250, 2.500, 3.000 mm
Max. lengths	3.000 mm
Can be shortened by	any lengths

FIXING

Fixing	screw fixed to the floor with screws and dowels
--------	---

PERFORMANCE & CERTIFICATES

UL	UL 10C [R38166]
----	-----------------

COLORS

Silver anodized	ART.NO. P160090
-----------------	-----------------



AT 12712 S

- / panic threshold with Silicone compression gasket
- / effective sealing against draught, light and noise



TECHNICAL DATA

Application	at the threshold of hinged single action doors
Gasket material	self-extinguishing silicone
Carrier material	aluminum, anodized
Working temperature	-40°C to +200°C

DIMENSIONS

Width x height	125 x 12 mm
Bottom gap size	6 - 10 mm
Standard lengths	1.000, 1.250, 2.250, 2.500, 3.000 mm
Max. lengths	3.000 mm
Can be shortened by	any lengths

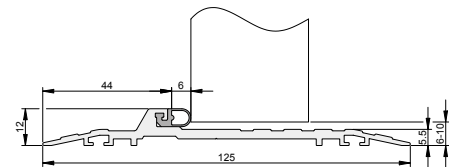
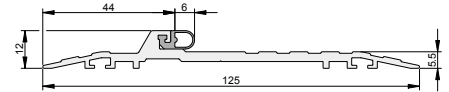

FIXING

Fixing	screw fixed to the floor with screws and dowels
--------	---

PERFORMANCE & CERTIFICATES

UL	UL 10C (R38166)
----	-----------------

COLORS [carrier, gasket]	ART.NO.	ACCESSORIES [incl. in delivery]
Silver anodized, grey	3-201	S022



AT 12713 S

- / panic threshold with silicone compression gasket
- / comes with water tight bedding gasket for effective acoustic sealing and vibration control
- / effective sealing against rain, draught, light and noise



TECHNICAL DATA

Application	at the threshold of hinged single action doors
Gasket material	self-extinguishing silicone; bottom seal: PVC
Carrier material	aluminum, anodized
Working temperature	-15°C to +60°C

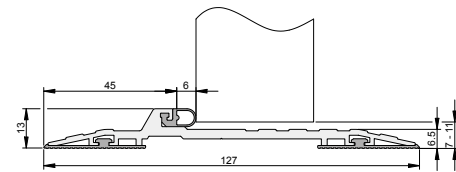
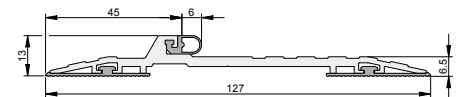

DIMENSIONS

Width x height	127 x 13 mm
Bottom gap size	7 - 11 mm
Standard lengths	1.000, 1.250, 2.250, 2.500, 3.000 mm
Max. lengths	3.000 mm
Can be shortened by	any lengths

FIXING

Fixing	screw fixed to the floor with screws and dowels
--------	---

PERFORMANCE & CERTIFICATES

UL	UL 10C [R38166]
----	-----------------

COLORS [carrier, gasket]	ART.NO.	ACCESSORIES [incl. in delivery]
Silver anodized, grey	3-202	S022

6 Threshold plates
6.3 panic thresholds

athmer.com



AT 12713 V

/ panic threshold with gasket provides additional threshold acoustics

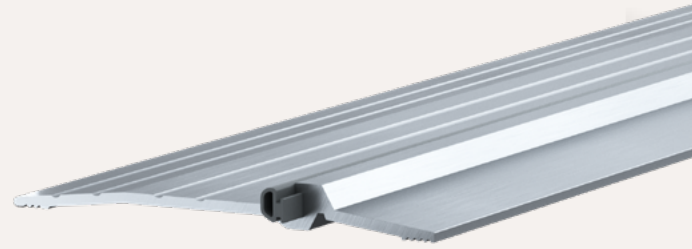

TECHNICAL DATA

Application	at the threshold of hinged single action doors
Gasket material	vinyl PVC
Carrier material	aluminum, anodized
Working temperature	-15°C to +60°C

DIMENSIONS

Width x height	127 x 13 mm
Bottom gap size	7 - 10 mm
Standard lengths	1.000, 1.250, 2.250, 2.500, 3.000 mm
Max. lengths	3.000 mm
Can be shortened by	any lengths

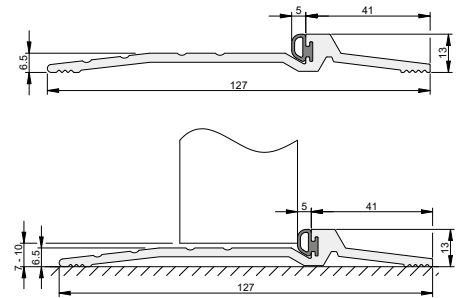

FIXING

Fixing	screw fixed to the floor with screws and dowels
--------	---

PERFORMANCE & CERTIFICATES

UL	UL 10C [R38166]
----	-----------------

COLORS [carrier, gasket]	ART.NO.
Silver anodized, grey	P160087





AT 07019 V

/ ramp threshold with compression gasket

TECHNICAL DATA

Application	at the threshold of hinged single action doors
Carrier material	aluminum, anodized
Gasket material	vinyl PVC
Working temperature	-15°C to +60°C

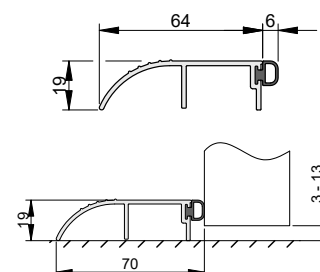

DIMENSIONS

Width x height	70 x 19 mm
Bottom gap size	3 - 13 mm
Standard lengths	1.000, 2.250, 2.500, 3.000 mm
Max. lengths	3.000 mm
Can be shortened by	any lengths

FIXING

Fixing	screw fixed to the floor with screws and anchors
--------	--

PERFORMANCE & CERTIFICATES

UL	UL 10C [R38166]
----	-----------------

COLORS [carrier, gasket]	ART.NO.
Silver anodized, grey	P160199



AT 09019 V

/ ramp threshold with compression gasket

TECHNICAL DATA

Application	at the threshold of hinged single action doors
Carrier material	aluminum, anodized
Gasket material	vinyl PVC,
Working temperature	-15°C to +60°C

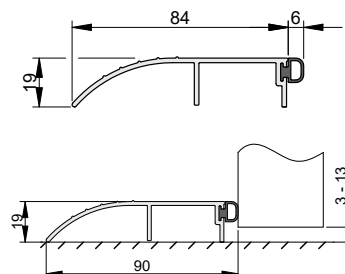

DIMENSIONS

Width x height	90 x 19 mm
Bottom gap size	3 - 13 mm
Standard lengths	1.000, 2.250, 2.500, 3.000 mm
Max. lengths	3.000 mm
Can be shortened by	any lengths

FIXING

Fixing	screw fixed to the floor with screws and anchors
--------	--

PERFORMANCE & CERTIFICATES

UL	UL 10C [R38166]
----	-----------------

COLORS [carrier, gasket]

Silver anodized, grey

ART.NO.

P160200



RG 7040

- / overhead rain drip guard
- / channels rain water from entrance doors
- / suitable for single and double leaf doors

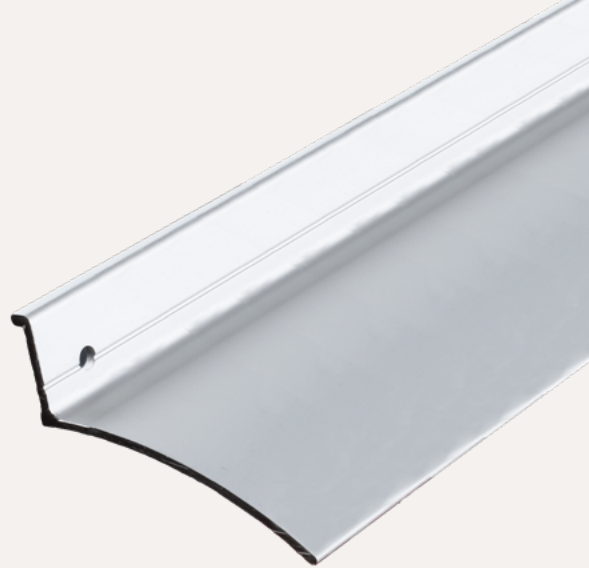

TECHNICAL DATA

Application	at the head of external doors
Material	aluminum, anodized

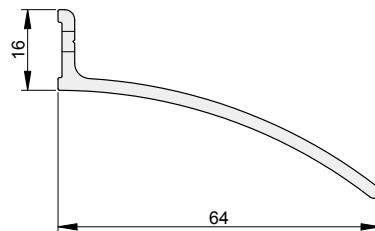

DIMENSIONS

Standard lengths	1000, 1250, 2250, 2500, 3000 mm
Maximum lengths	3.000 mm
Can be shortened by	any length

FIXING

Fixing	screw fixed to the wall above the door
--------	--

PERFORMANCE & CERTIFICATES

UL	UL 10C (R38166)
----	-----------------

COLORS

Silver anodized	ART.NO. P160123
-----------------	-----------------

RG 7721

- / overhead rain drip guard
- / channels rain water from entrance doors
- / suitable for single and double leaf doors



TECHNICAL DATA

Application	at the head of external doors
Material	aluminum, anodized

DIMENSIONS

Standard lengths	1000, 1250, 2250, 2500, 3000 mm
Maximum lengths	3.000 mm
Can be shortened by	any length

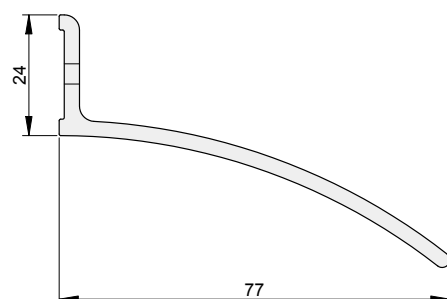

FIXING

Fixing	screw fixed to the wall above the door
--------	--

COLORS

Silver anodized

ART.NO.

P160124